

### 4CH/8CH Compact DWDM Module

#### Features

- ◆ Low Insertion Loss & High Isolation
- ◆ Compact Design
- ◆ High Reliability and Stability

#### Applications

- ◆ DWDM System
- ◆ PON Networks
- ◆ CATV Links

#### Specifications

Parameters		Specification		Unit
		4Ch DWDM	8CH DWDM	
Center Wavelength		ITU±0.07		nm
Passband		ITU±0.11		nm
Operating Wavelength		C band		nm
ChannelSpace		0.8		nm
Insertion Loss		1.4	2.0	dB
Isolation	Adjacent Channel	25		dB
	Non-adjacent Channel	35		dB
Passband Ripple		0.5		dB
Polarization Dependment Loss		0.3		dB
Polarization Mode Dispersion		0.1		ps
Return Loss		45		dB
Directivity		50		dB
Maximum Optical Power		500		mW
Operating Temperature		-5~65		°C
Storage Temperature		-40~86		°C
Box package		55×25×6.5		mm

Notes: 1. Specified without connectors. 2. Add an additional 0.2dB loss per connector.

#### Dimension

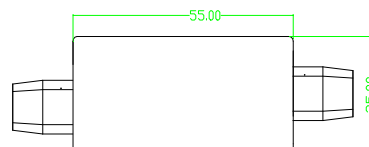

# Passive Optical Components

## Data Sheet

### Ordering information



Optical Interconnection Design Innovator

CDWDM	-	*		*	***	-	*	*	*	*
		WDM Type	Channel Number	Module Type	Start Channel		fiber Type	fiber Length	Input	Output
		1=100GHz	2=2 CH	M=Mux	C11=11CH		L=900um Loose Tube	00=1m	0=None	0=None
		2=200GHz	4=4CH	D=Demux	C12=12CH		B=Bare fiber	05=0.6m	1=FC/UPC	1=FC/UPC
			8=8CH	3=Demux & Mux				10=1.0m	2=FC/APC	2=FC/APC
				4=OADM					3=SC/UPC	3=SC/UPC
									4=SC/APC	4=SC/APC
									5=LC/UPC	5=LC/UPC
									6=LC/APC	6=LC/APC